



# Parques Lineares de Londrina

## Mobiliário Urbano Catálogo de Detalhes

MARÇO 2019



O projeto de mobiliário urbano para os Parques Lineares de Londrina teve como ponto de partida tanto as características do ambiente em que será instalado (os fundos de vale), quanto o conforto e segurança dos usuários.

Os parques situados em fundos de vale devem ser pensados de modo distinto de outros espaços de lazer devido às suas características ambientais: declividade topográfica, umidade do ar e do solo, trechos de característica pantanosa, etc. Além disso, por serem locais que acomodam a água da chuva do seu entorno, é comum a ocorrência de pontos de erosão quando o sistema de captação de águas pluviais é insuficiente.

Portanto, optou-se pela criação de mobiliário em concreto armado, de modo a resistir a intempéries e ser compatível com as condições ambientais dos locais onde será instalado. Além de possibilitar baixo custo na sua produção, o concreto oferece durabilidade suficiente para garantir vida longa às peças. A utilização de poucos elementos de encaixe e partes móveis em metal minimiza o risco de vandalismo, preserva as peças de corrosão, diminui a necessidade manutenção e facilita a substituição, quando necessário.

A estética do mobiliário é manifestada por formas prismáticas de aspecto monolítico, marcadas por linhas simples e robustas. As peças foram criadas cada uma como parte de um sistema modular, possibilitando diversos arranjos entre elas. O desenho do bebedouro foi elaborado a partir dos fundamentos legais de acessibilidade, fazendo com que atenda cadeirantes, crianças, adultos e até mesmo animais de estimação. As arestas arredondadas dos bancos e a própria ergonomia das peças proporcionam conforto aos usuários e tem como objetivo estimular sua maior permanência nos parques.

O uso de seladores acrílicos no acabamento das superfícies valoriza a cor e a textura natural do concreto, dando a impressão de que cada peça é uma pedra bruta moldada para o uso a que foi destinada. A intenção é que o mobiliário não dispute visualmente com o seu entorno, mas que se harmonize a ele, mantendo a própria natureza como protagonista do espaço.

De modo mais amplo e não menos importante, o projeto tem como objetivo convidar os londrinenses a se apropriar da natureza urbana - que é de todos - e incorporá-la ao seu cotidiano. Portanto, a função social do mobiliário é tanto promover novos usos, quanto qualificar aqueles já existentes: brincar, pescar, caminhar, pedalar, contemplar a natureza, proporcionar encontros e conversas e, em consequência, sensibilizar sobre as questões ambientais que estão próximas de nós, estimulando a corresponsabilidade e o espírito preservacionista.

# Detalhes da comunicação visual



Parque  
Lindóia

RGB CORES

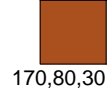

170,80,30



250,125,0

QR CODE

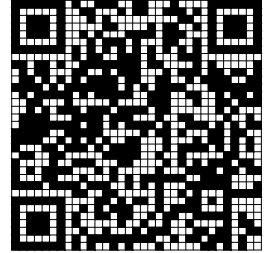

<http://ippul.londrina.pr.gov.br/index.php/parques-lineares/lindoia.html>



Parque  
Igapó

RGB CORES

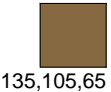

135,105,65



200,160,50

QR CODE

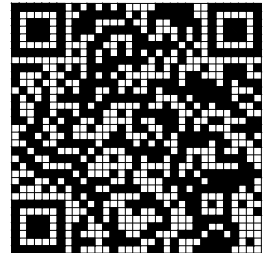

<http://ippul.londrina.pr.gov.br/index.php/parques-lineares/igapo.html>



Parque  
Jacutinga

RGB CORES

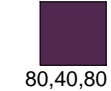

80,40,80



100,50,100

QR CODE

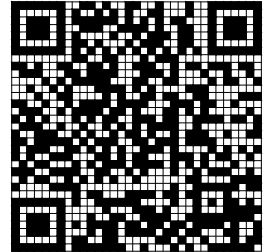

<http://ippul.londrina.pr.gov.br/index.php/parques-lineares/jacutinga.html>



Parque  
Limoeiro

RGB CORES

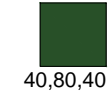

40,80,40



60,120,60

QR CODE

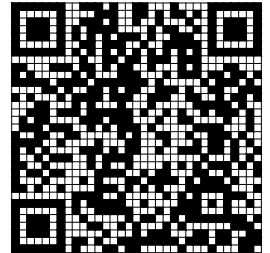

<http://ippul.londrina.pr.gov.br/index.php/parques-lineares/limoeiro.html>



Parque  
Cafezal

RGB CORES

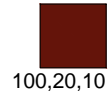

100,20,10



170,40,30

QR CODE

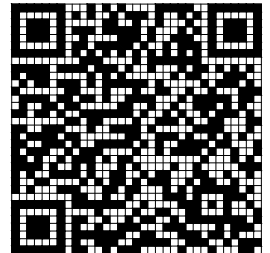

<http://ippul.londrina.pr.gov.br/index.php/parques-lineares/cafezal.html>

## BANCOS

- BC1** Banco cúbico sem encosto em concreto armado pré-moldado polido
- BC2** Banco trapezoidal sem encosto em concreto armado pré-moldado polido
- BC3** Banco prismático com encosto em concreto armado pré-moldado polido
- BC4** Banco arqueado sem encosto em concreto armado pré-moldado polido
- BC5** Banco casca sem encosto em concreto armado pré-moldado polido
- BR1** Banco rampa sem encosto em concreto armado pré-moldado polido

## TÓTENS

- TP1** Tótem pequeno de balizamento para indicação de distancia do percurso implantados a cada 100 metros sem QR Code em concreto armado pré-moldado polido - 1,30m de altura
- TG1** Tótem grande de indicação de entrada dos parques lineares com QR Code em concreto armado pré-moldado polido - 4,00m de altura

## PLAYGROUND

- PG1** Paineis lúdicos em concreto armado pré-moldado polido vazado com círculo
- PG2** Paineis lúdicos em concreto armado pré-moldado polido vazado com losango
- PG3** Paineis lúdicos em concreto armado pré-moldado polido vazado com triângulo
- PG4** Paineis lúdicos em concreto armado pré-moldado polido vazado com forma irregular
- PG5** Túnel em arco alto em concreto armado pré-moldado polido
- PG6** Túnel em arco baixo em concreto armado pré-moldado polido
- PG7** Monte em casca pequeno de concreto armado pré-moldado polido diâmetro 1,25m
- PG8** Monte em casca grande de concreto armado pré-moldado polido diâmetro 2,00m

## EXERCÍCIO FÍSICO

- BF** Módulo de barras fixas e abdominal pré-moldado polido com barras ajustáveis em aço inox escovado

## OUTROS EQUIPAMENTOS

- BE1** Bebedouro em concreto armado pré-moldado polido e aço inox acessível com três alturas: adulto/cadeirante, infantil e animais de estimação
- LX1** Lixeira coberta em concreto armado pré-moldado polido com portinhola rebatível em aço galvanizado
- PC1** Paraciclo com barra arqueada em aço inox escovado

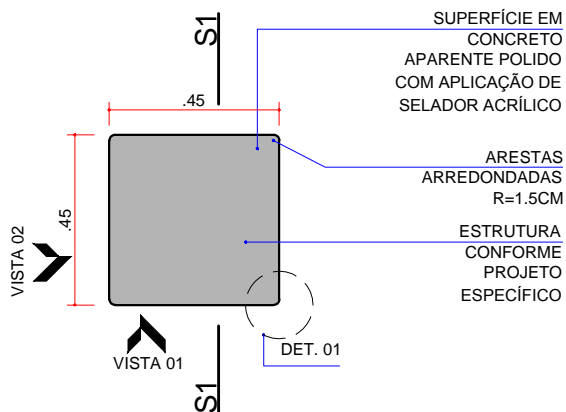

**PLANTA BC1**  
ESCALA 1:20

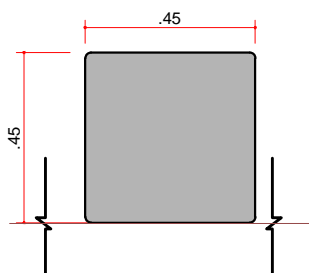

**VISTA 01**  
ESCALA 1:20

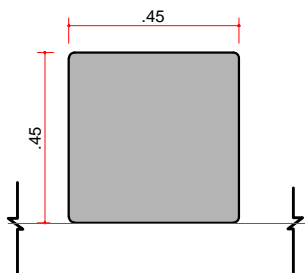

**VISTA 02**  
ESCALA 1:20

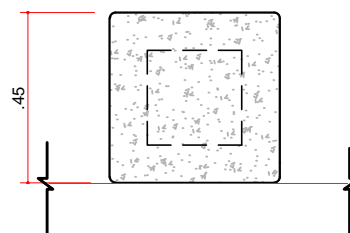

**SEÇÃO 1**  
ESCALA 1:20

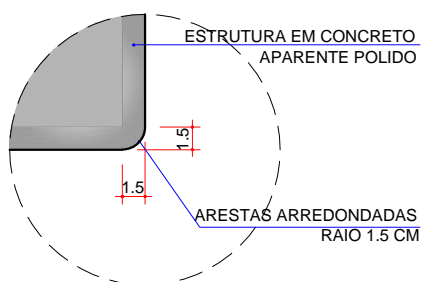

**DET. 1**  
ESCALA 1:5



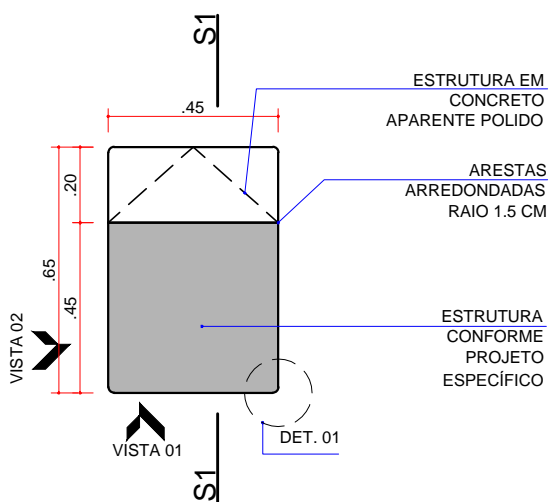

**PLANTA BC2**  
ESCALA 1:20

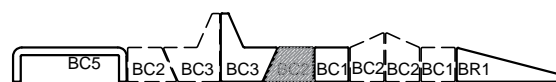
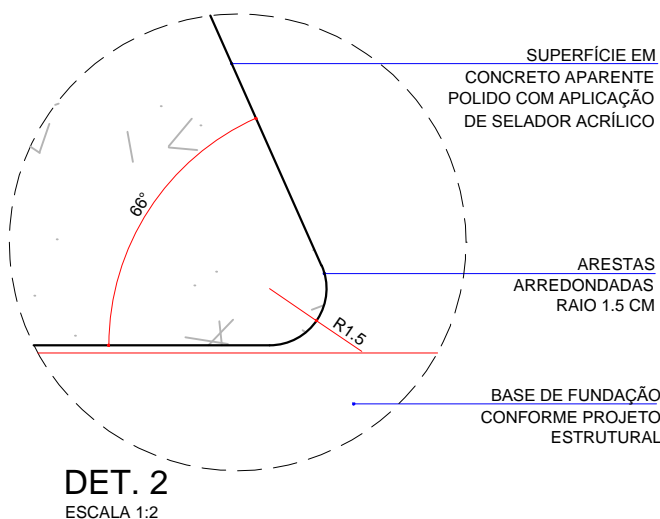
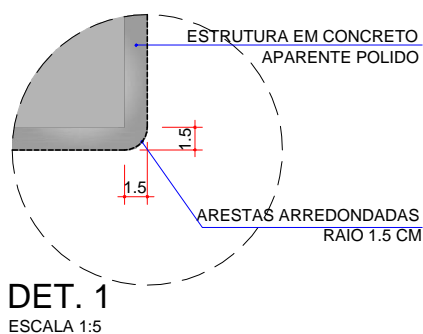
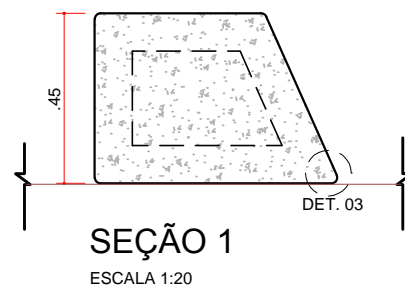
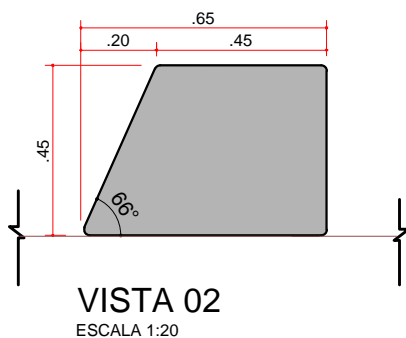
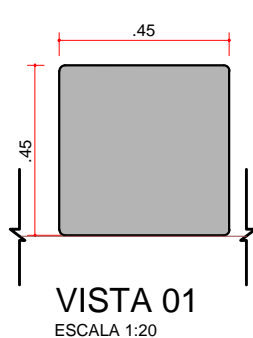

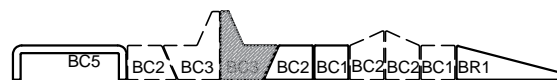
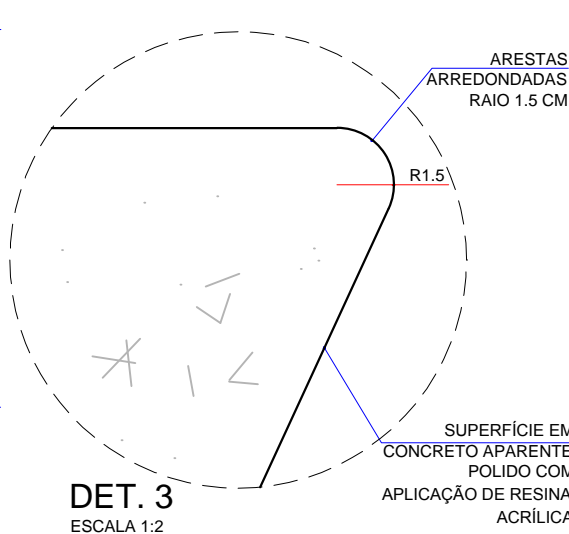
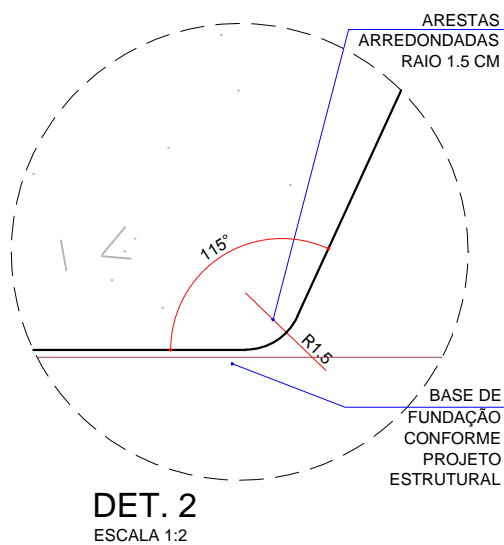
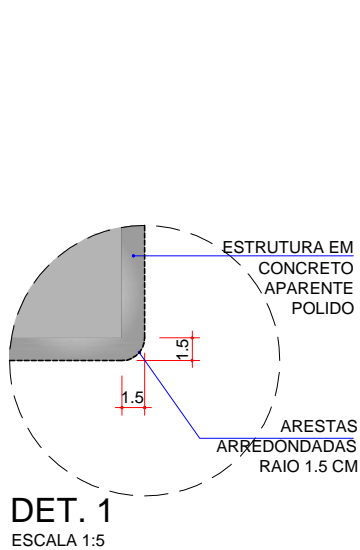
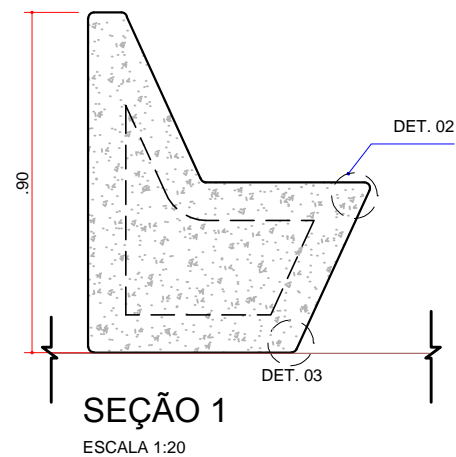
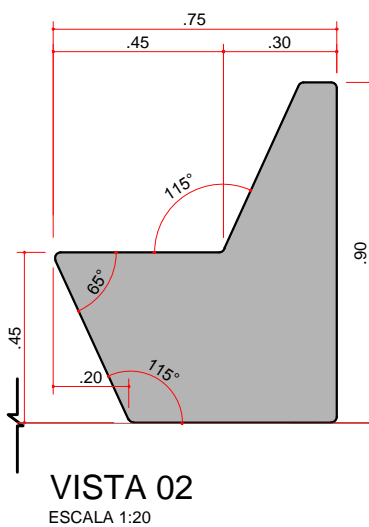
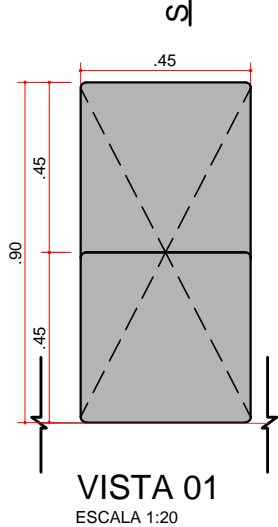
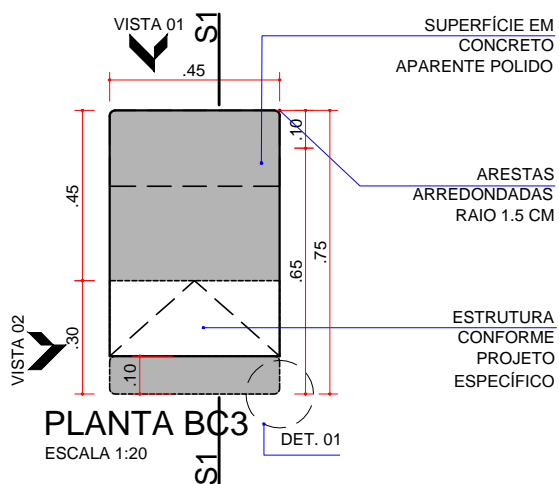

MOBILIÁRIO URBANO - CATÁLOGO DE DETALHES  
ELEMENTO: BANCO PRISMÁTICO COM ENCOSTO (0.75M)

CÓDIGO: **BC3**

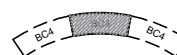
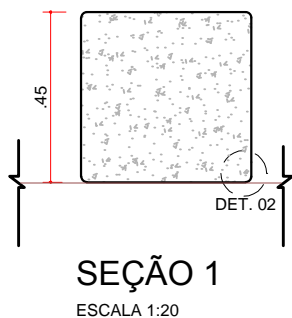
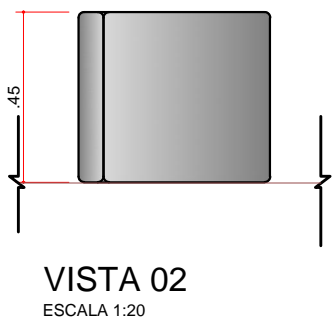
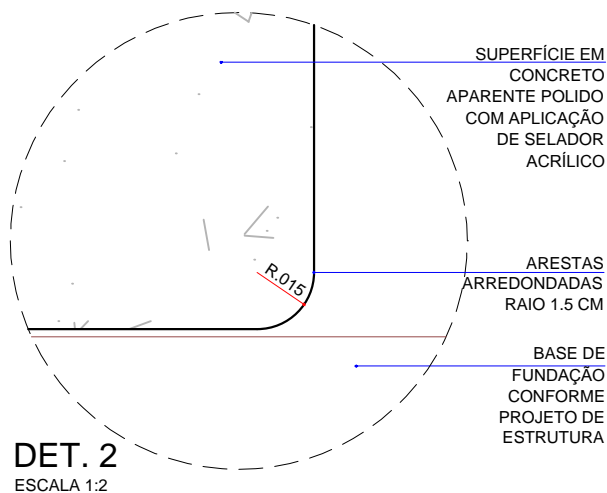
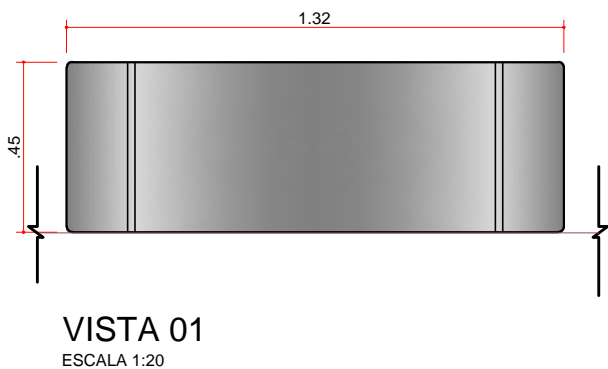
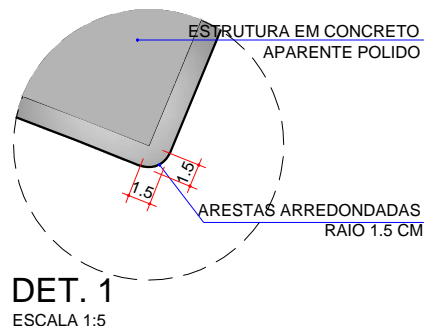
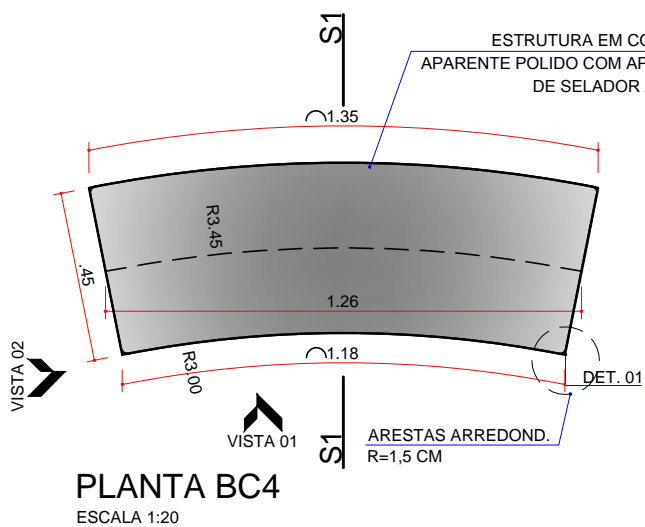



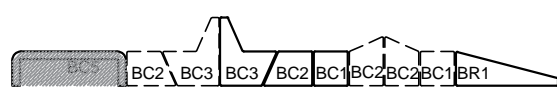
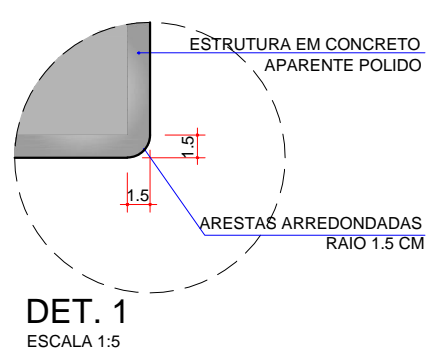
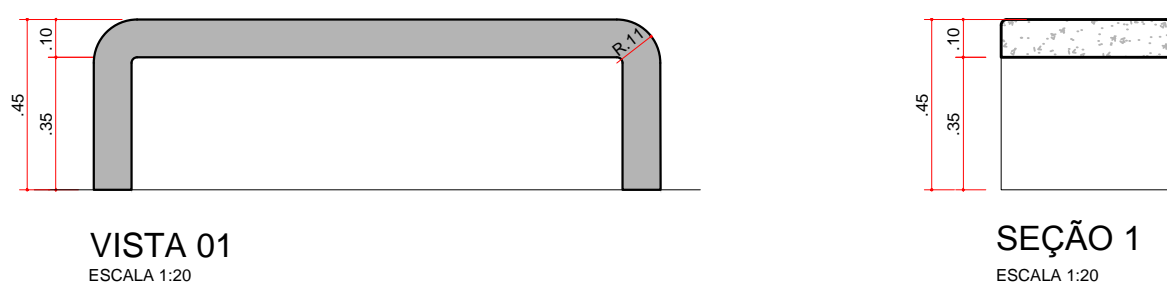
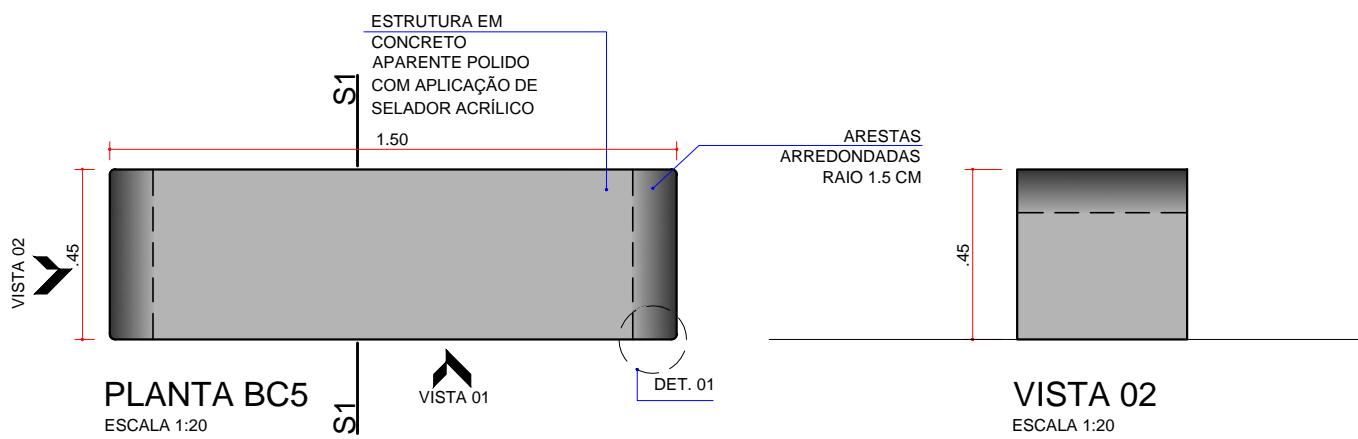

MOBILIÁRIO URBANO - CATÁLOGO DE DETALHES  
 ELEMENTO: BANCO CASCA SEM ENCOSTO (1.50M)

CÓDIGO: **BC5**

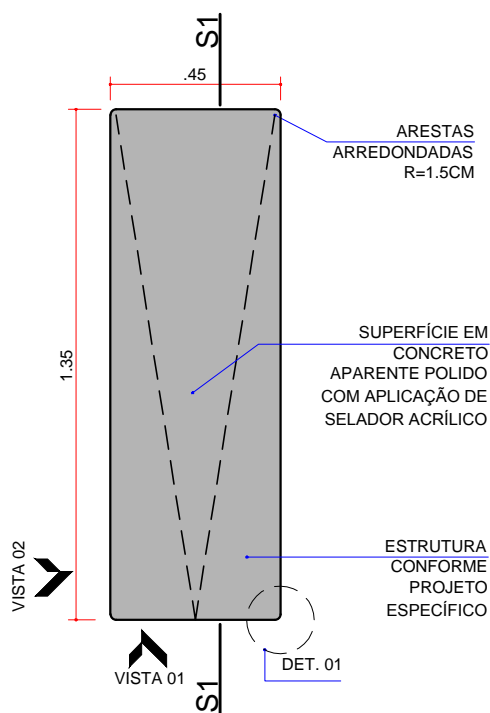

**PLANTA BR1**  
ESCALA 1:20

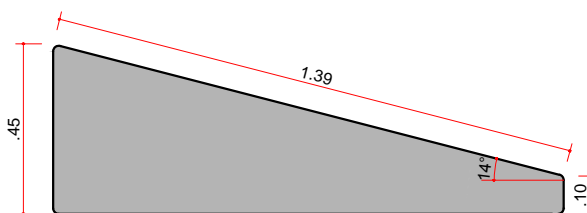

**VISTA 02**  
ESCALA 1:20

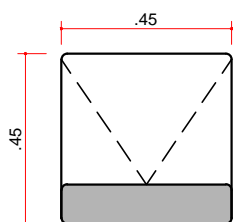

**VISTA 01**  
ESCALA 1:20

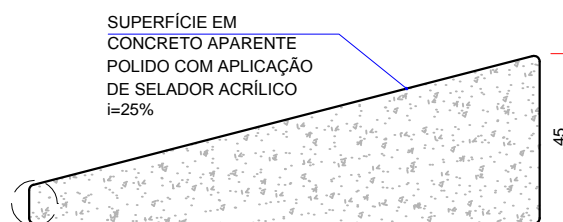

DET. 2

**SEÇÃO 1**

ESCALA 1:20

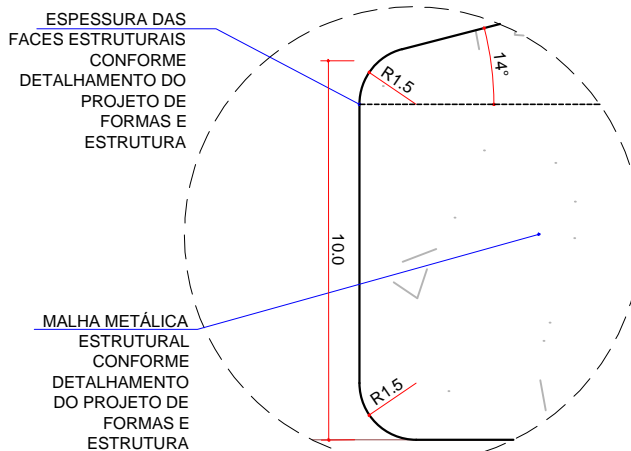

**DET. 2**  
ESCALA 1:2

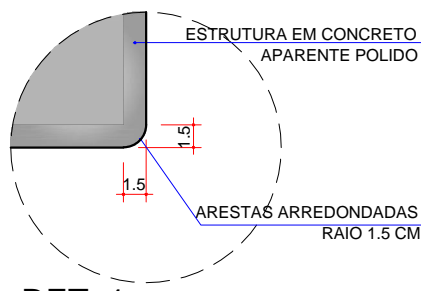

**DET. 1**  
ESCALA 1:5



MOBILIÁRIO URBANO - CATÁLOGO DE DETALHES  
ELEMENTO: BANCO RAMPA SEM ENCOSTO (1.35M)

CÓDIGO: **BR1**

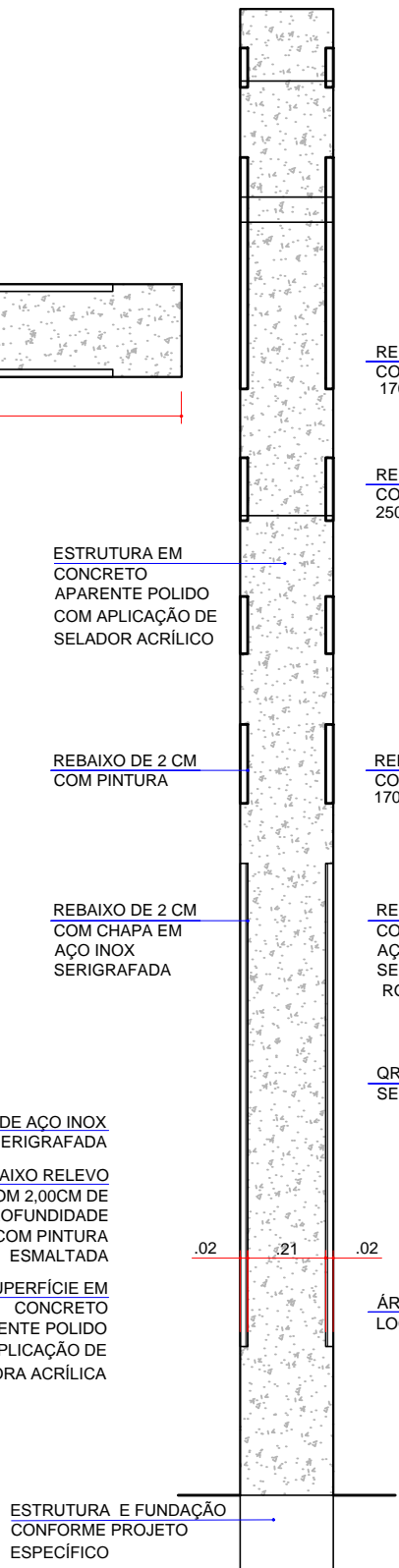
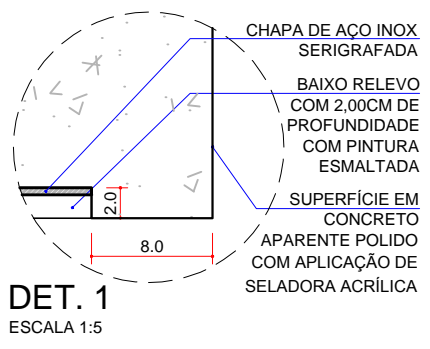
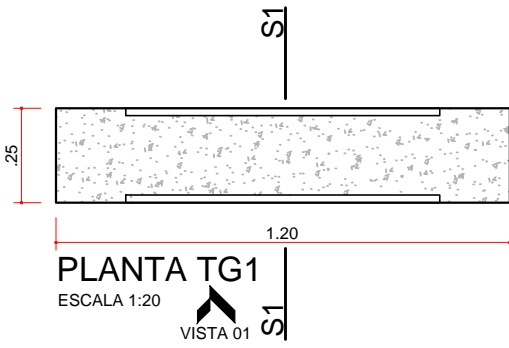

**SEÇÃO 01**  
ESCALA 1:20



**VISTA 01**  
ESCALA 1:20



VISTA 01  
ESCALA 1:20



VISTA 01  
ESCALA 1:20



VISTA 01  
ESCALA 1:20



VISTA 01  
ESCALA 1:20

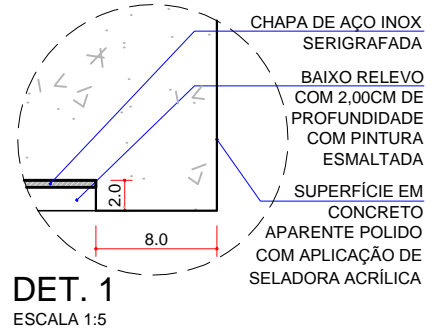
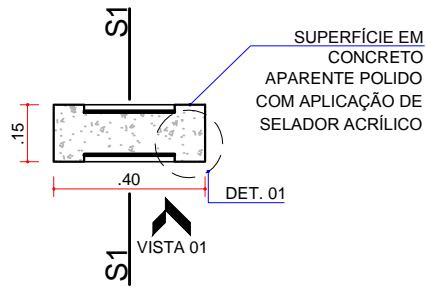

**PLANTA TP1**  
ESCALA 1:20

**DET. 1**  
ESCALA 1:5

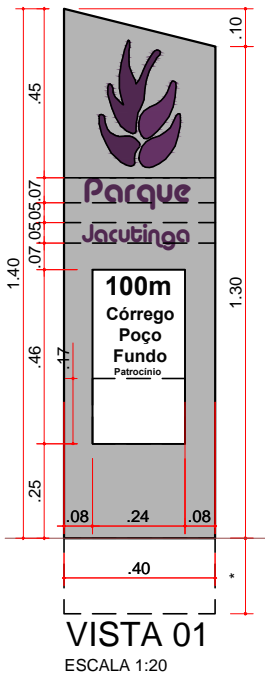
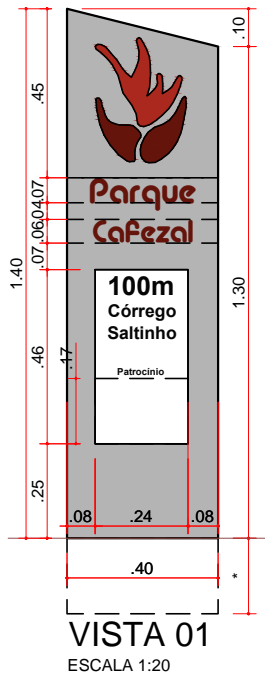
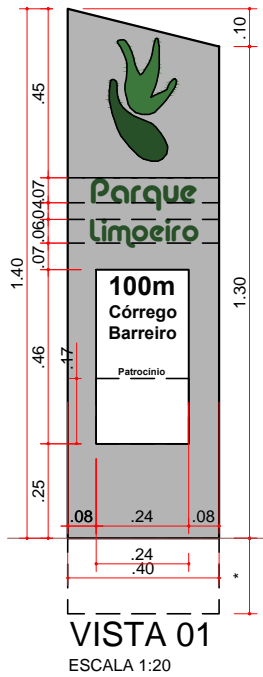
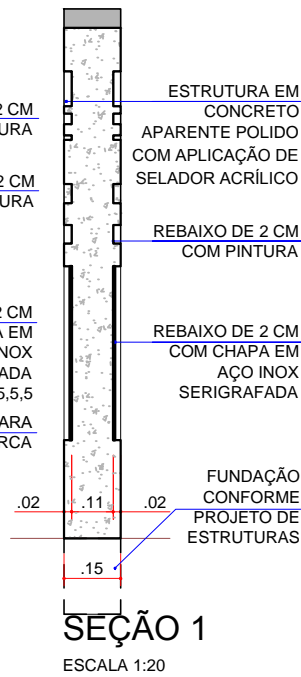
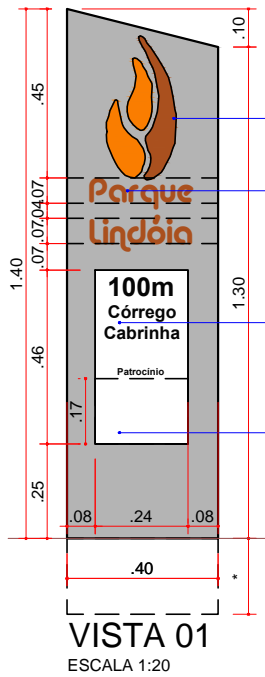
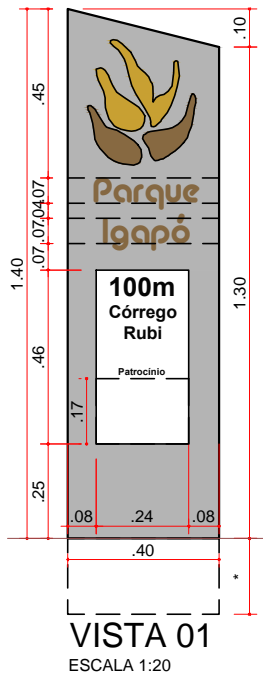

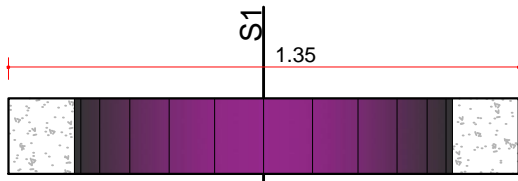

**PLANTA PG1**  
ESCALA 1:20

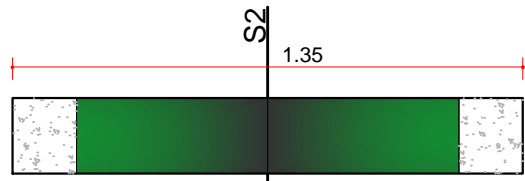

**PLANTA PG2**  
ESCALA 1:20

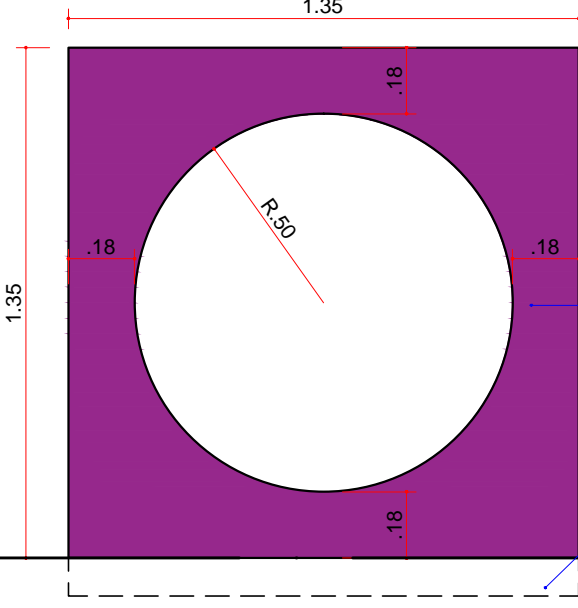

**VISTA 01**  
ESCALA 1:20

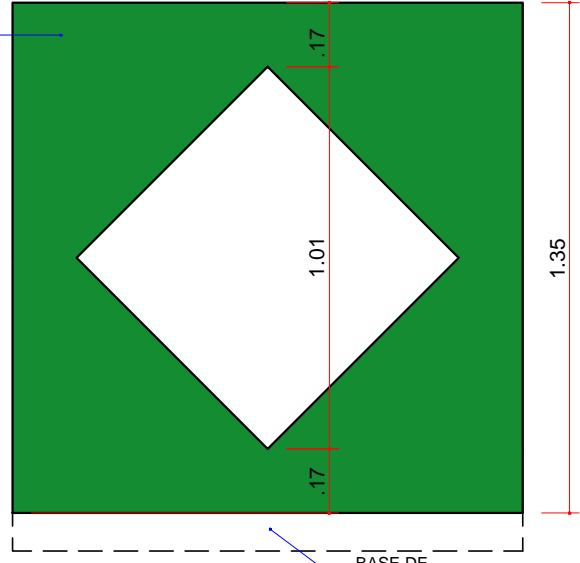

**VISTA 02**  
ESCALA 1:20

ESTRUTURA EM CONCRETO APARENTE POLIDO COM APLICAÇÃO DE PINTURA ESMALTE VERDE ESCURO RGB 20, 40, 50

ESTRUTURA EM CONCRETO APARENTE POLIDO COM APLICAÇÃO DE PINTURA ESMALTE VIOLETA ESCURO RGB 150, 40, 140

BASE DE FUNDAÇÃO CONFORME PROJETO DE ESTRUTURAS

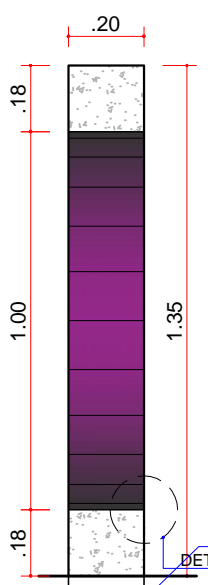

**SEÇÃO 1**  
ESCALA 1:20

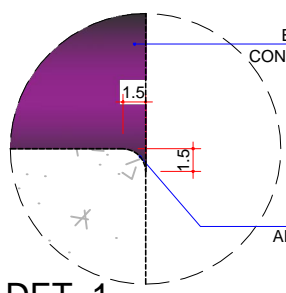

**DET. 1**  
ESCALA 1:5

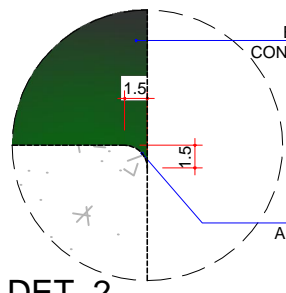

**DET. 2**  
ESCALA 1:5

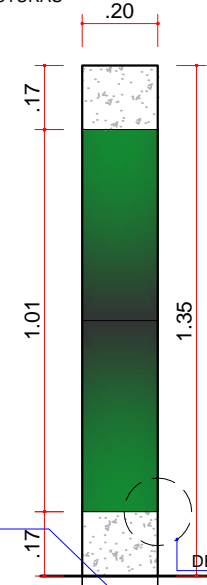

**SEÇÃO 2**  
ESCALA 1:20

ESTRUTURA EM CONCRETO POLIDO COM PINTURA ESMALTE

ARESTAS ARREDONDADAS RAIOS 1.5 CM

BASE DE FUNDAÇÃO CONFORME PROJETO DE ESTRUTURAS

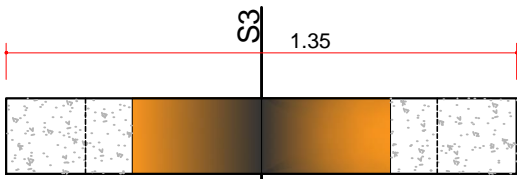

**PLANTA PG3**  
ESCALA 1:20

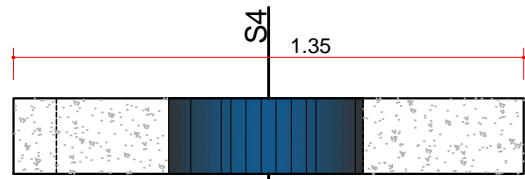

**PLANTA PG4**  
ESCALA 1:20

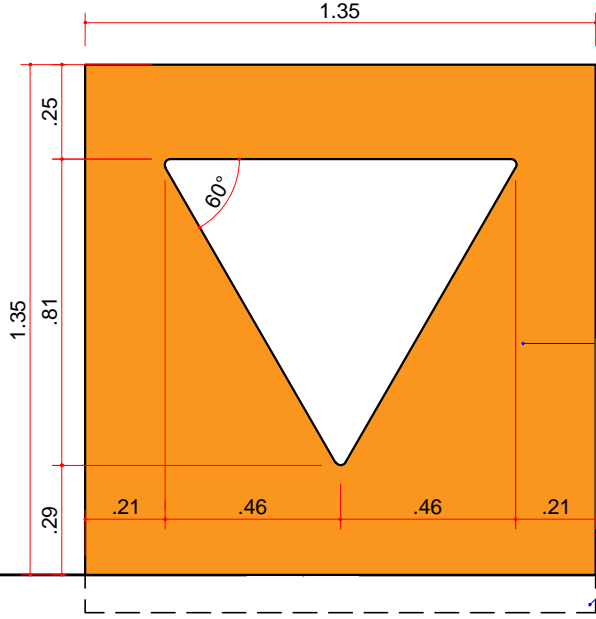

**VISTA 03**  
ESCALA 1:20

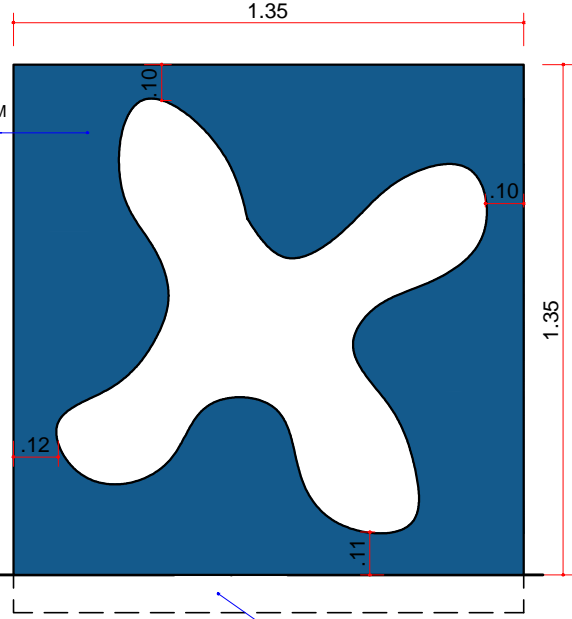

**VISTA 04**  
ESCALA 1:20

ESTRUTURA EM CONCRETO APARENTE POLIDO COM APLICAÇÃO DE PINTURA ESMALTE AZUL RGB 20, 90, 140

ESTRUTURA EM CONCRETO APARENTE POLIDO COM APLICAÇÃO DE PINTURA ESMALTE LARANJA RGB 250, 150, 30

BASE DE FUNDAÇÃO CONFORME PROJETO DE ESTRUTURAS

BASE DE FUNDAÇÃO CONFORME PROJETO DE ESTRUTURAS

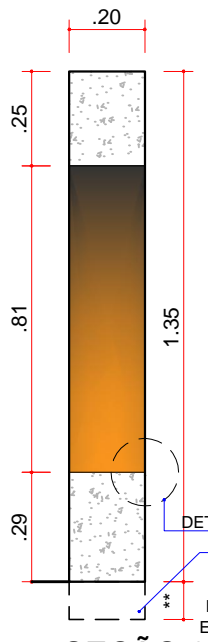

**SEÇÃO 3**  
ESCALA 1:20

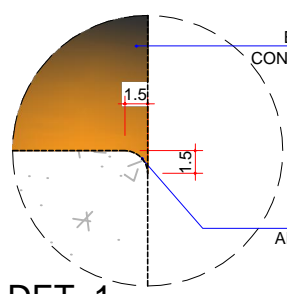

**DET. 1**  
ESCALA 1:5

ESTRUTURA EM CONCRETO POLIDO COM PINTURA ESMALTE

ARESTAS ARREDONDADAS RAIOS 1.5 CM

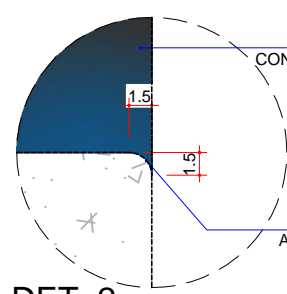

**DET. 2**  
ESCALA 1:5

ESTRUTURA EM CONCRETO POLIDO COM PINTURA ESMALTE

ARESTAS ARREDONDADAS RAIOS 1.5 CM

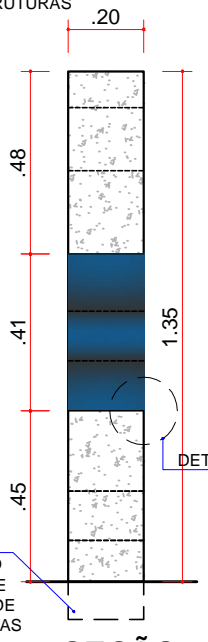

**SEÇÃO 4**  
ESCALA 1:20

BASE DE FUNDAÇÃO CONFORME PROJETO DE ESTRUTURAS

DET. 02



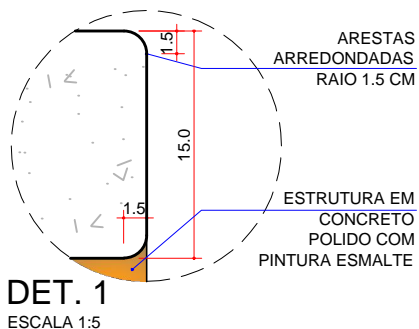
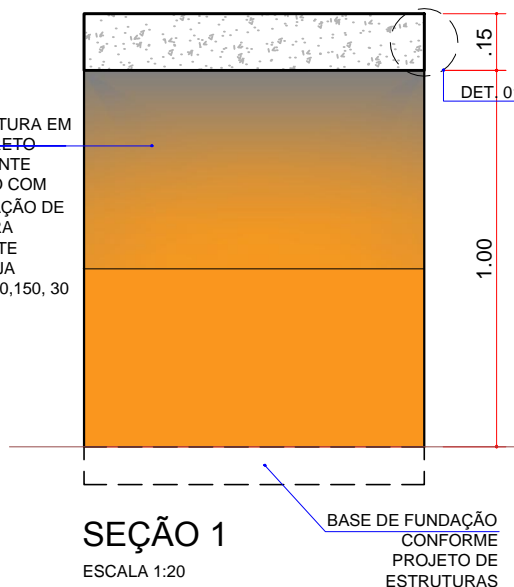
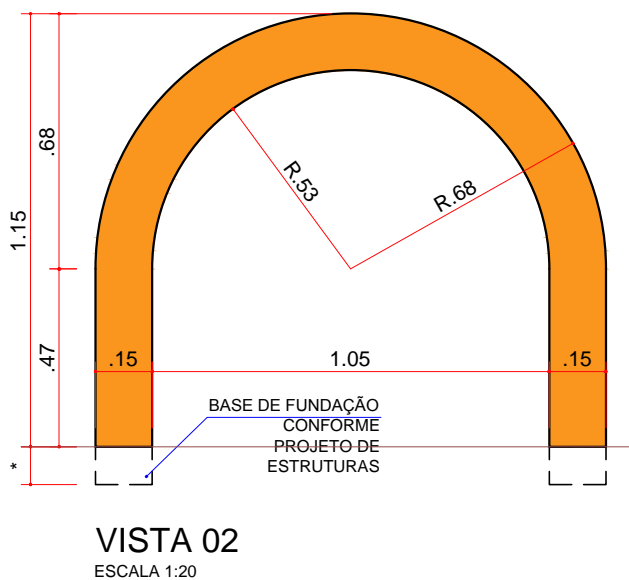
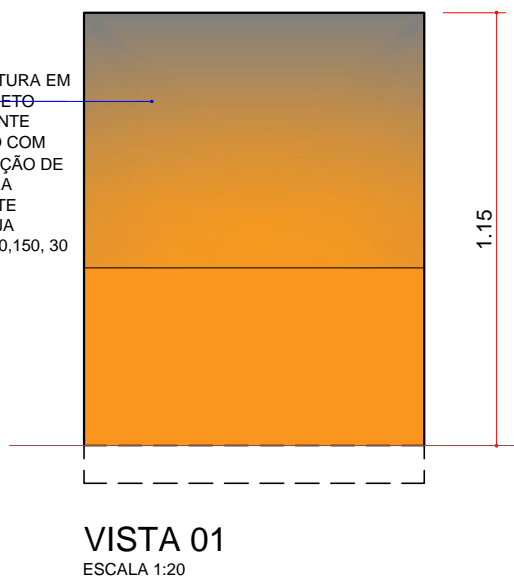
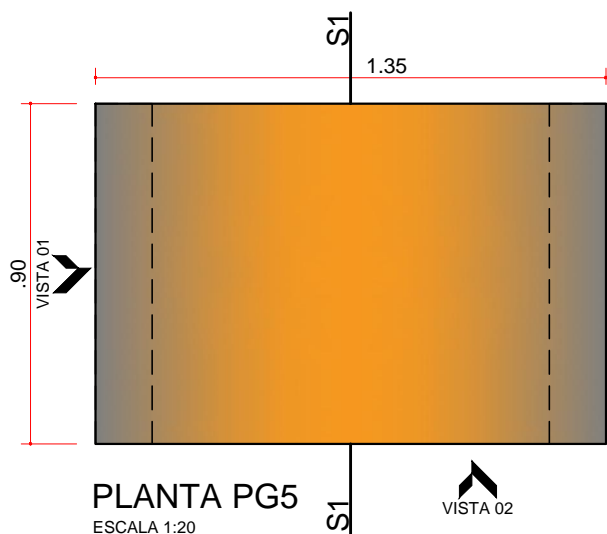

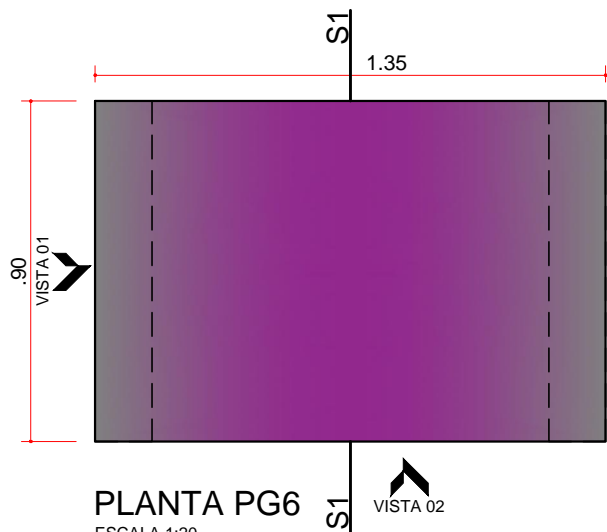

**PLANTA PG6**  
ESCALA 1:20

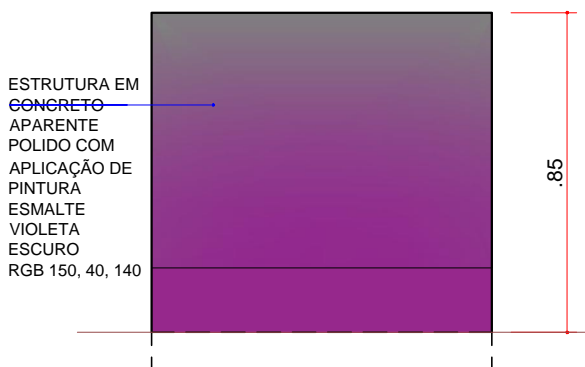

**VISTA 01**  
ESCALA 1:20

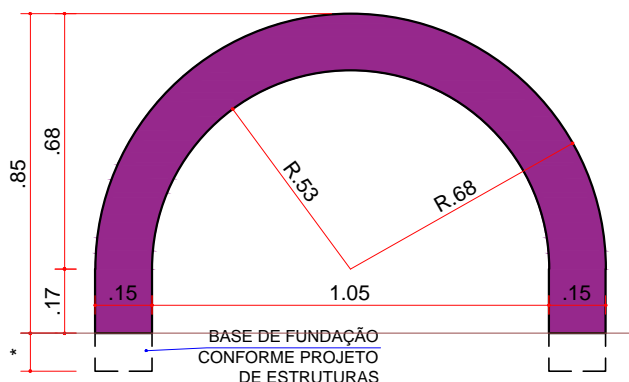

**VISTA 02**  
ESCALA 1:20

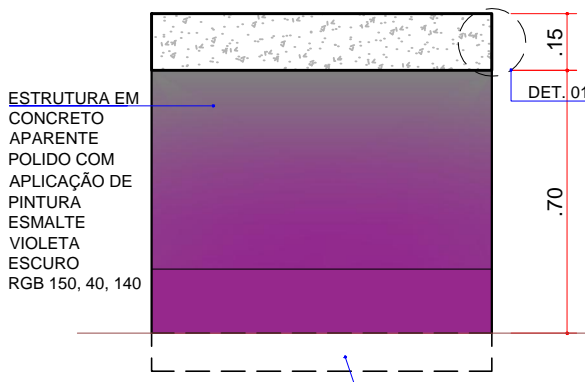

**SEÇÃO 1**  
ESCALA 1:20

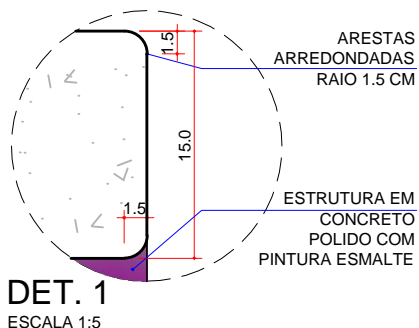

**DET. 1**  
ESCALA 1:5

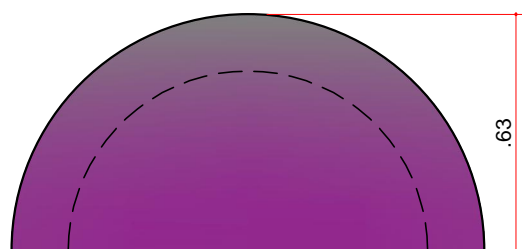
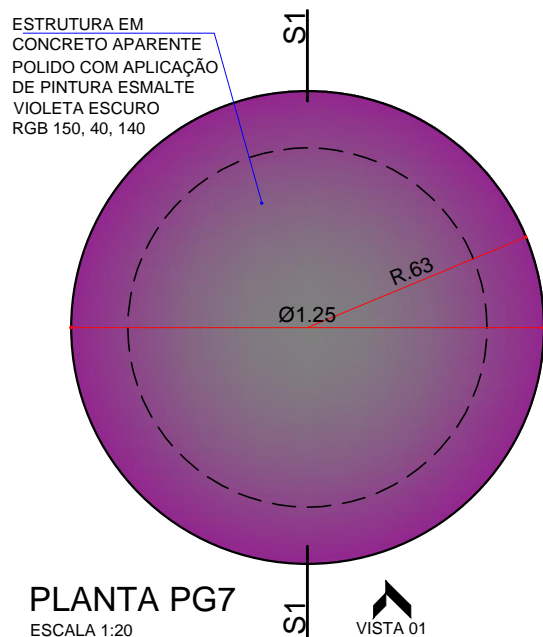

VISTA 01  
ESCALA 1:20

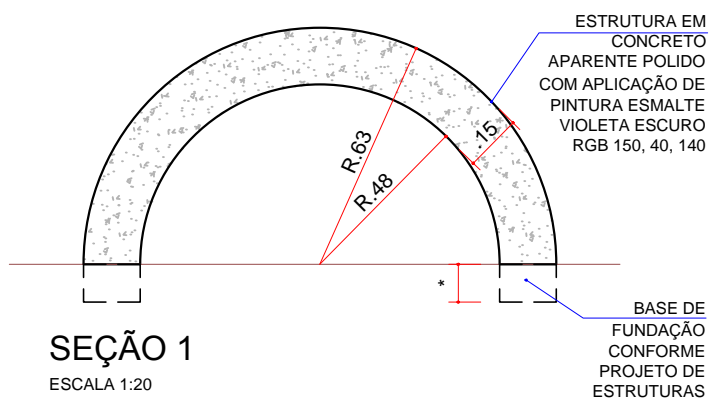

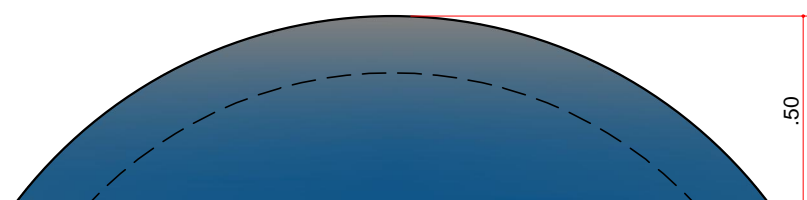
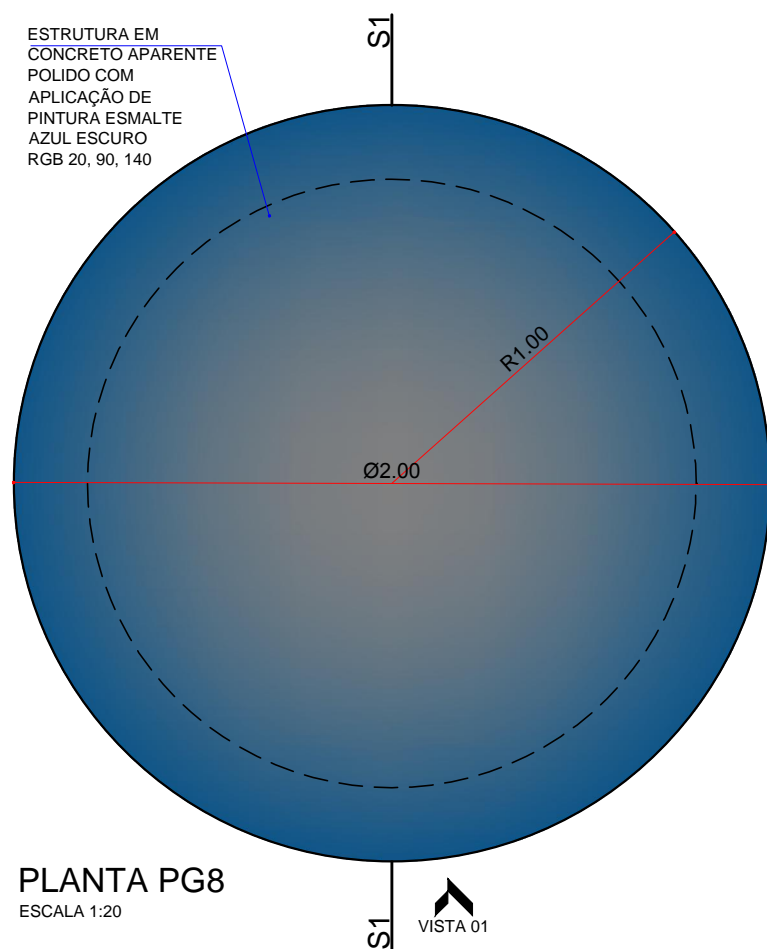

VISTA 01

ESCALA 1:20

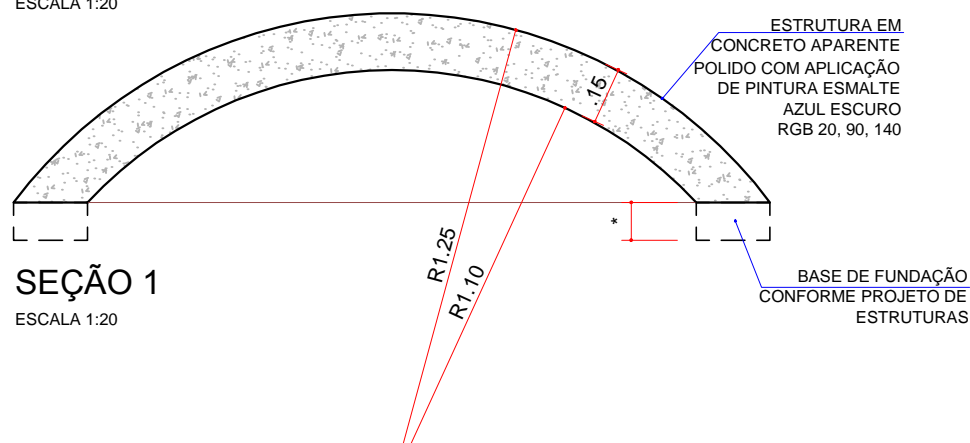

MOBILIÁRIO URBANO - CATÁLOGO DE DETALHES  
ELEMENTO: **PLAYGROUND MONTE EM CASCA (2.00X0.50)**

CÓDIGO: **PG8**

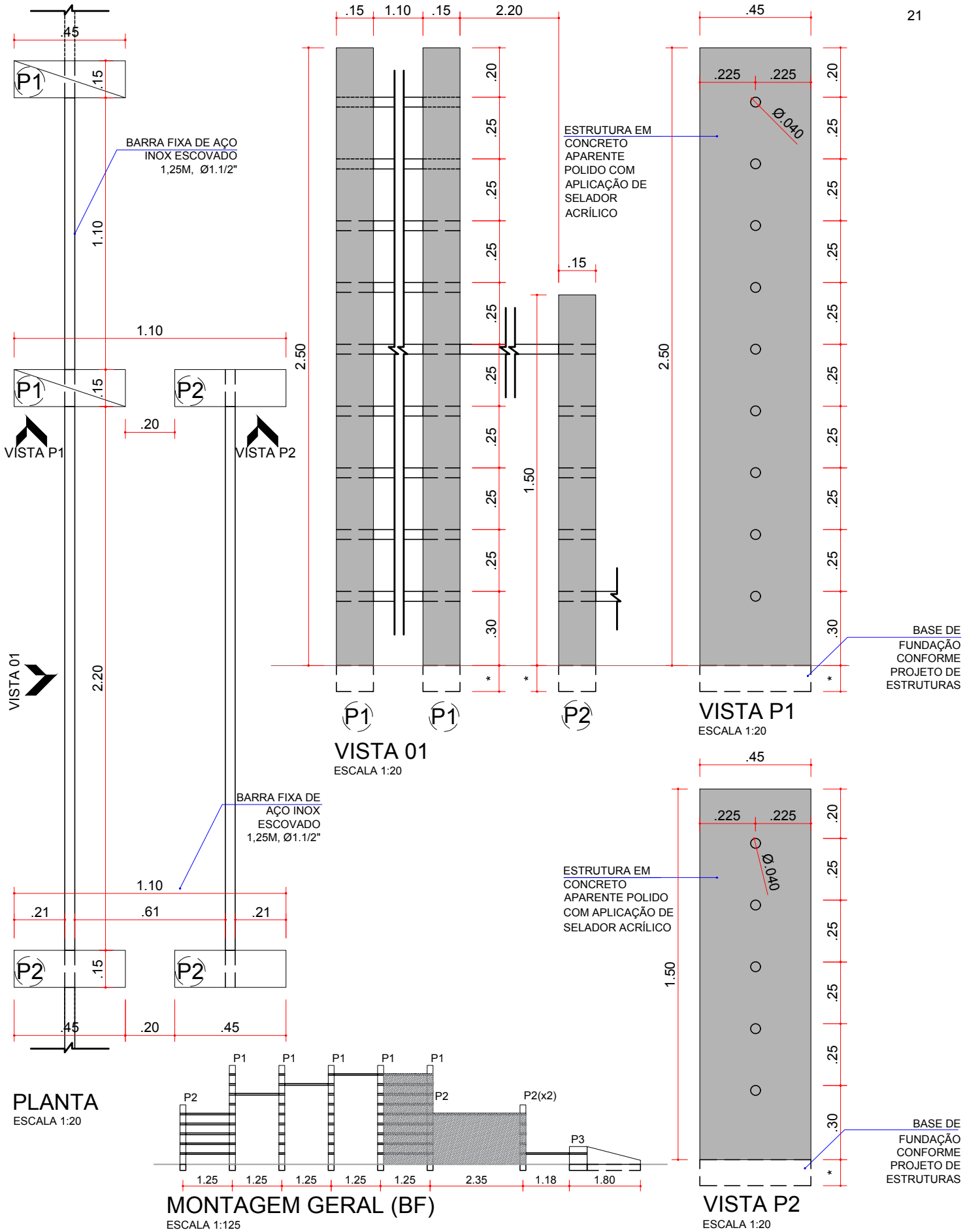

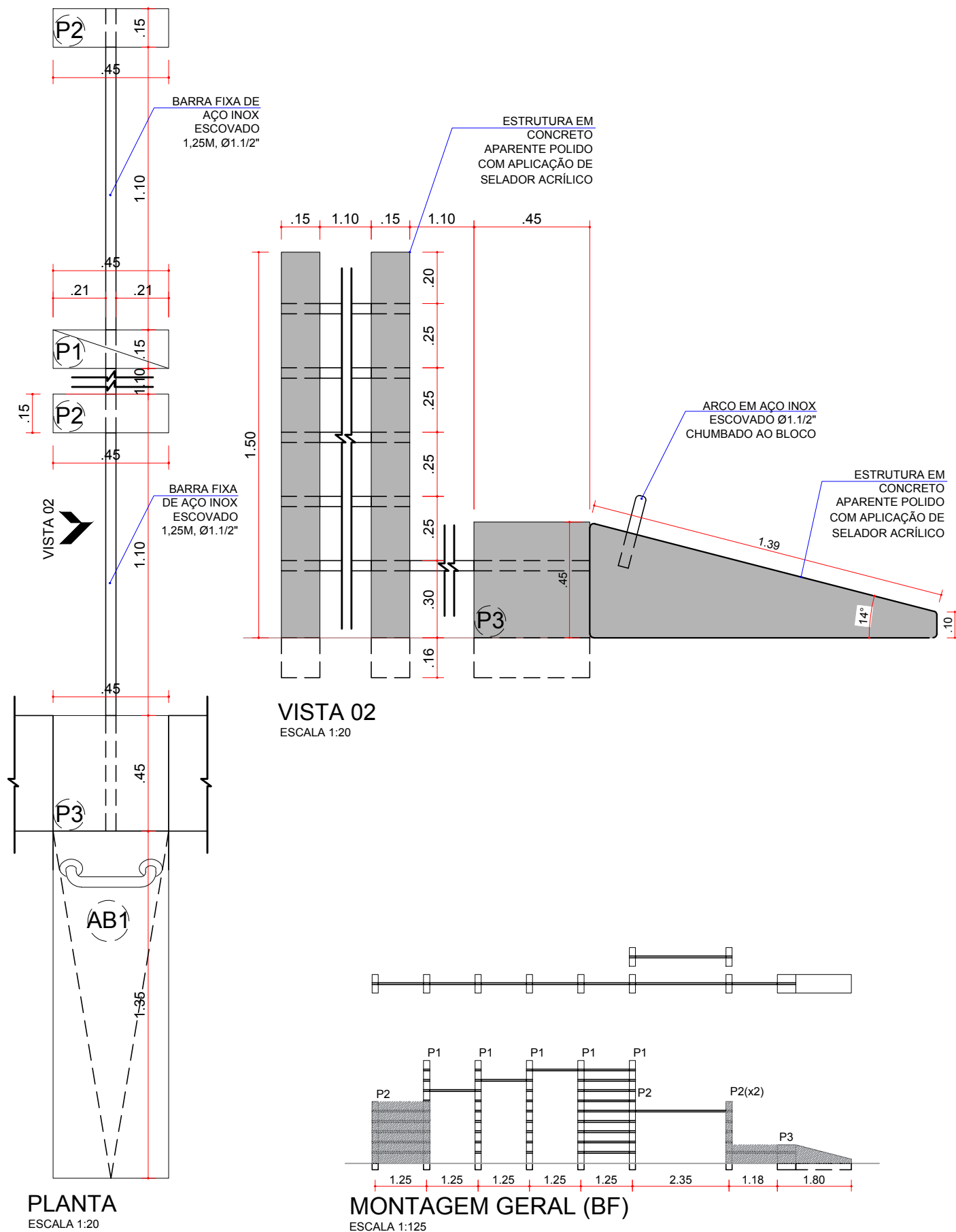

MOBILIÁRIO URBANO - CATÁLOGO DE DETALHES

ELEMENTO: BARRA FIXA, ESPALDAR BAIXO / ABDOMINAL

CÓDIGO: **BFX**

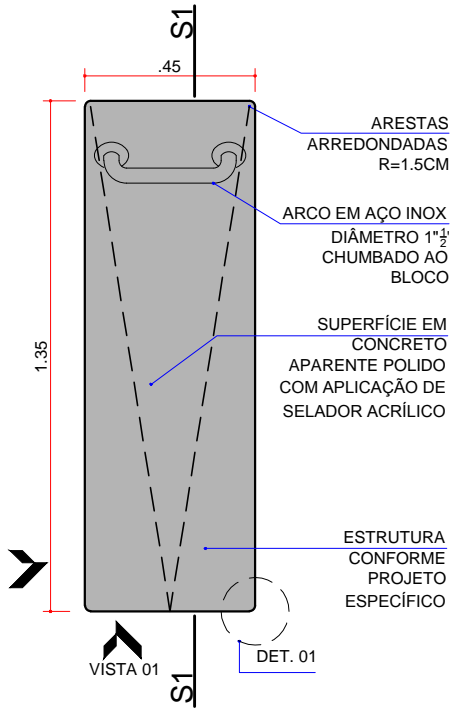

PLANTA AB1

ESCALA 1:20

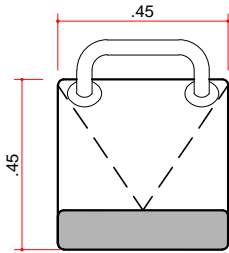

VISTA 02

ESCALA 1:20

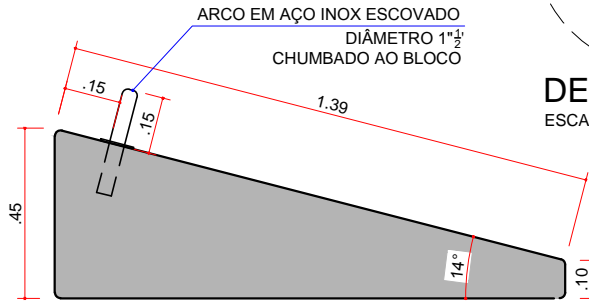

DET. 1

ESCALA 1:5

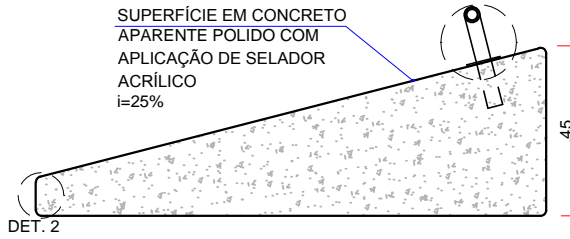

SEÇÃO 1

ESCALA 1:20

VISTA 01

ESCALA 1:20

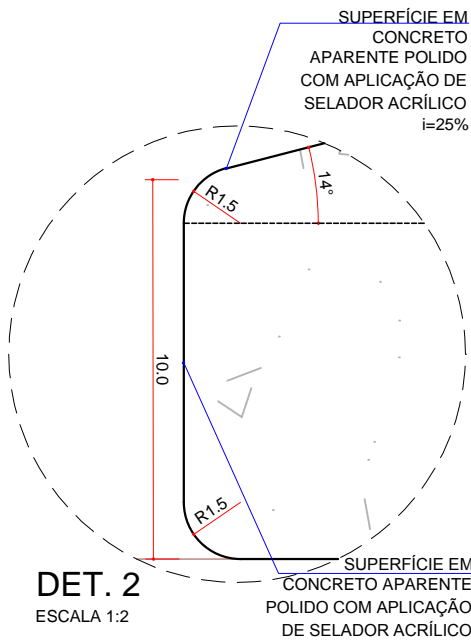

DET. 2

ESCALA 1:2

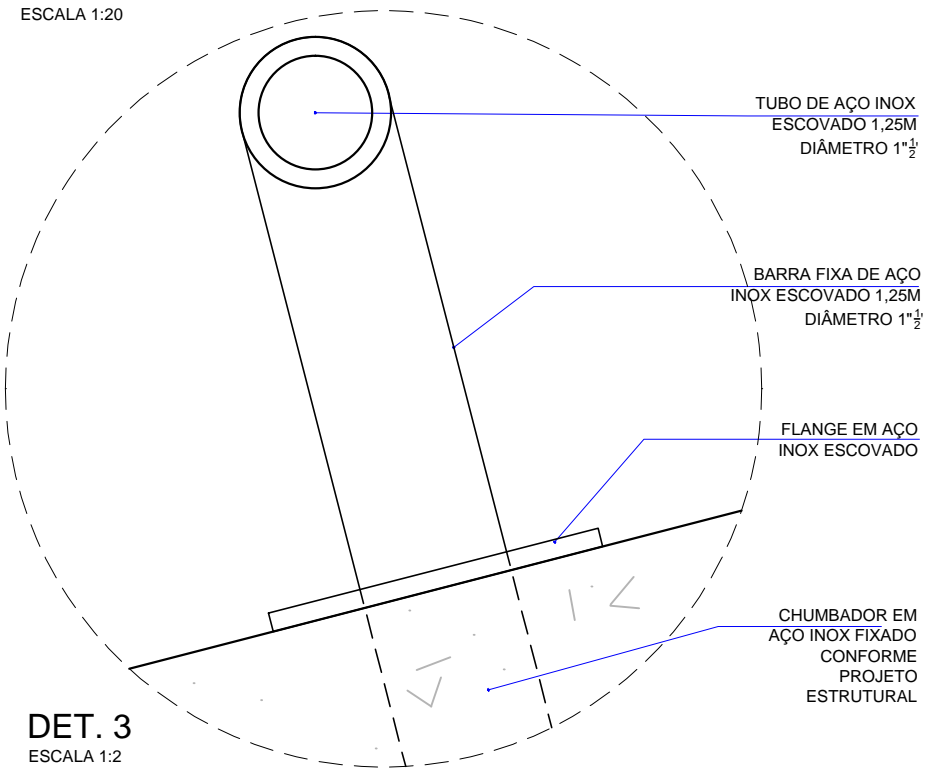

DET. 3

ESCALA 1:2

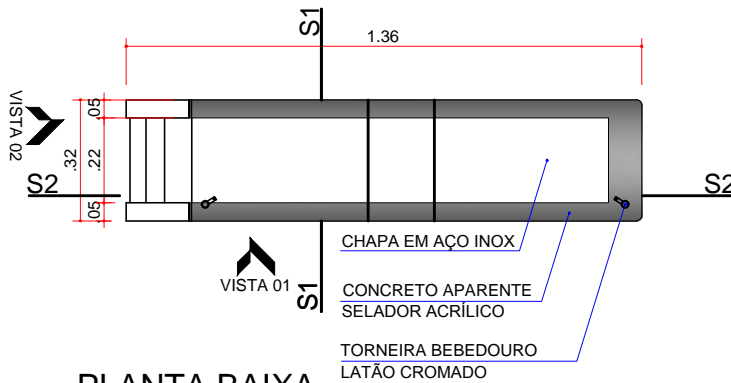

**PLANTA BAIXA**  
ESCALA 1:20



**PERSPECTIVA INTERNA**  
SEM ESCALA

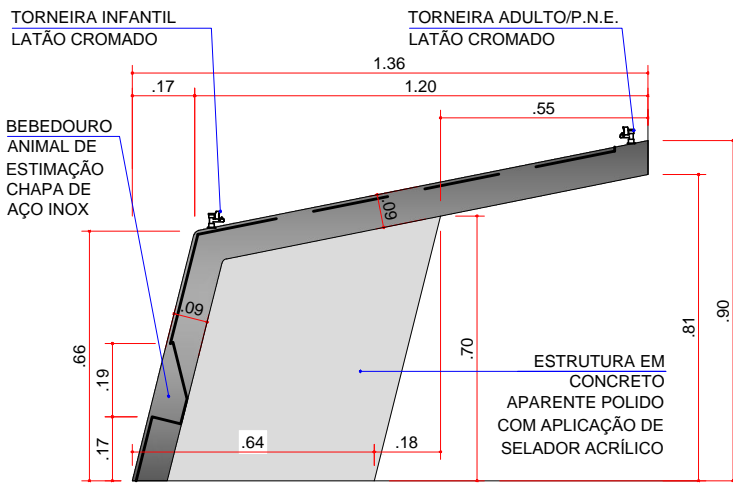

**VISTA 01**  
ESCALA 1:20

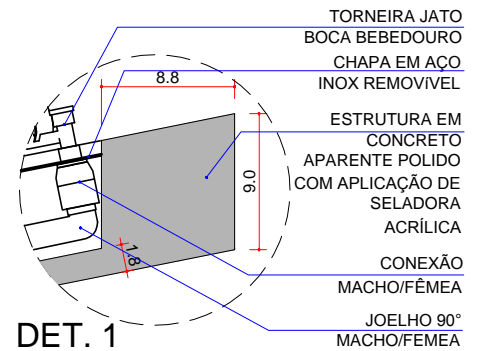

**DET. 1**  
ESCALA 1:5

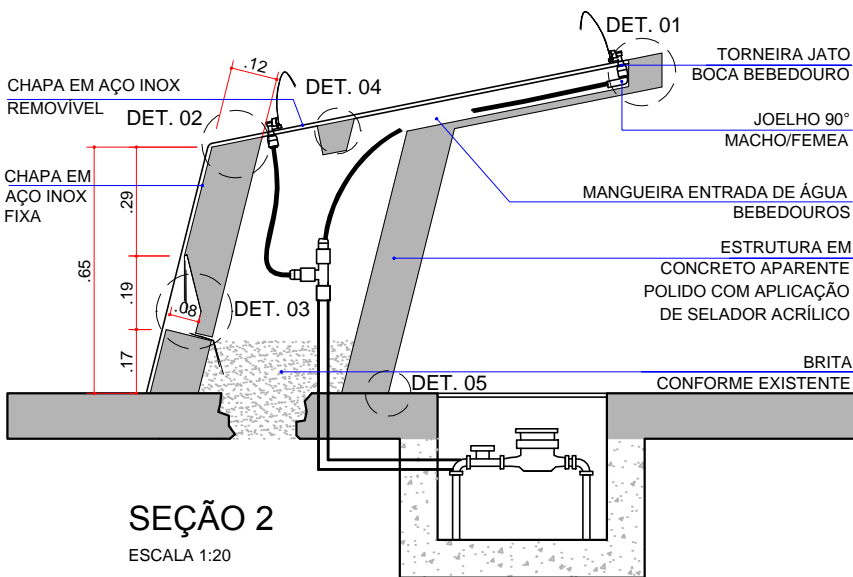

**SEÇÃO 2**  
ESCALA 1:20

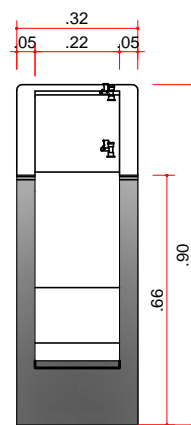

**VISTA 02**  
ESCALA 1:20

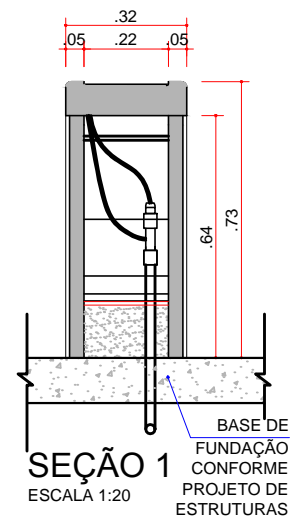

**SEÇÃO 1**  
ESCALA 1:20



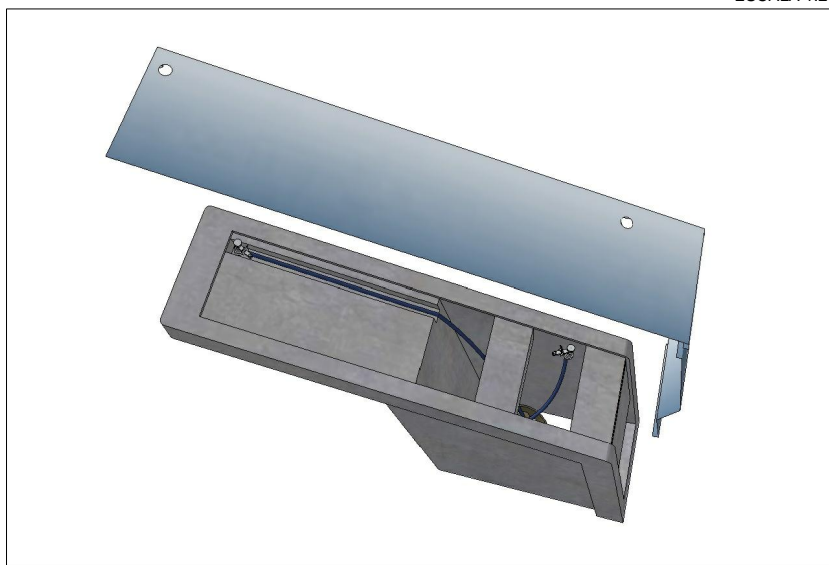
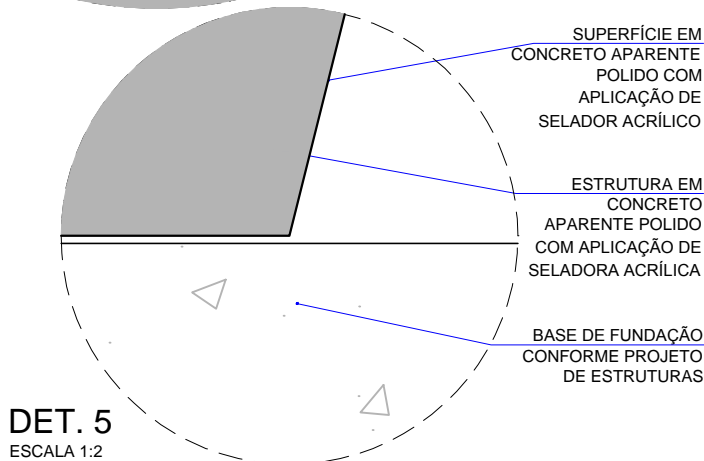
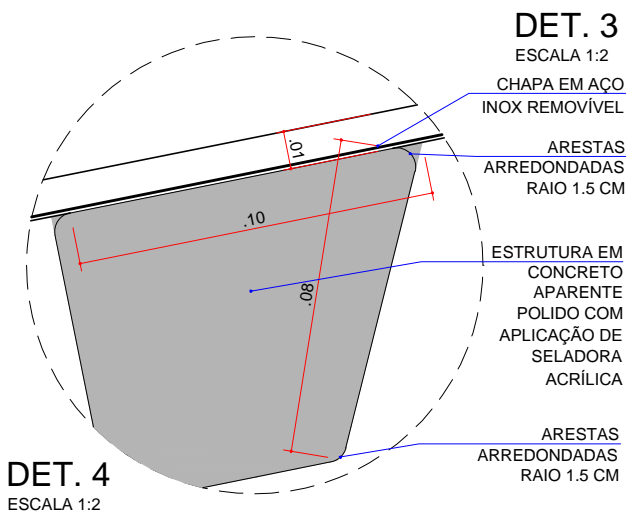
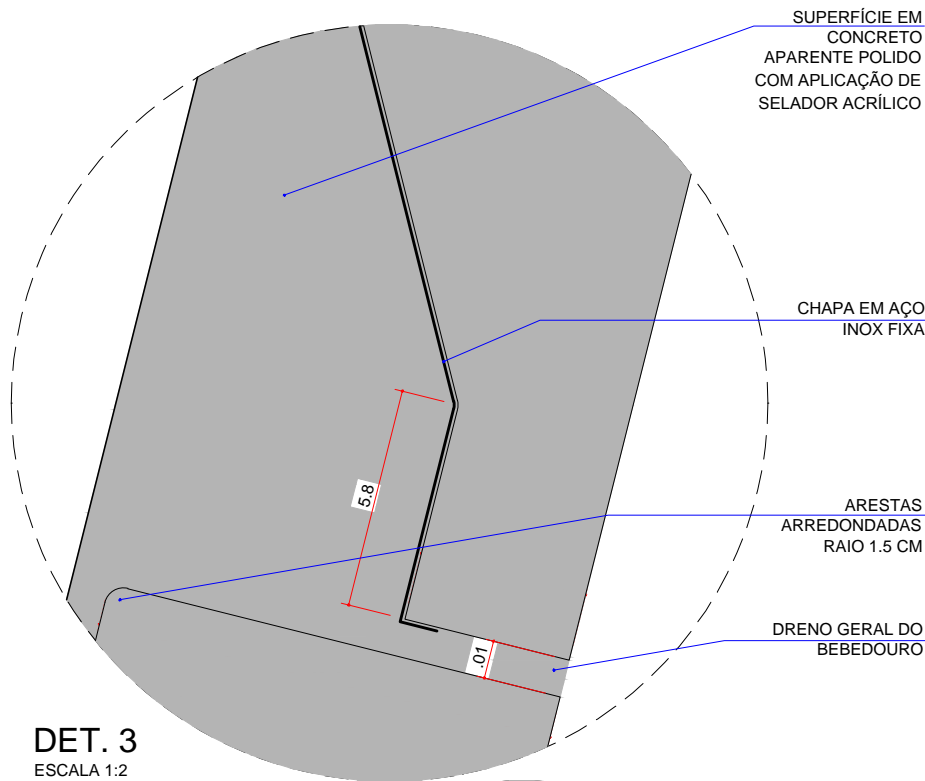
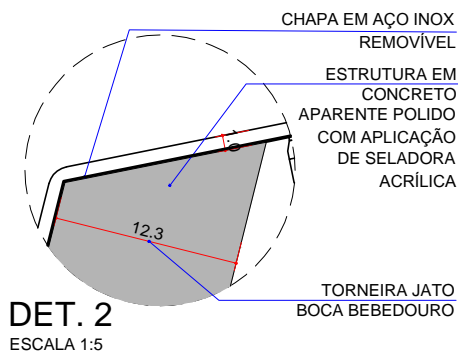

**PERSPECTIVA INTERNA**  
SEM ESCALA

MOBILIÁRIO URBANO - CATÁLOGO DE DETALHES

ELEMENTO: **BEBEDOURO ACESSÍVEL COM TRÊS ALTURAS (detalhe)**

CÓDIGO: **BE1**

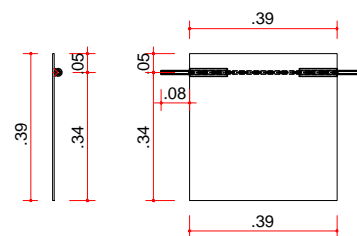
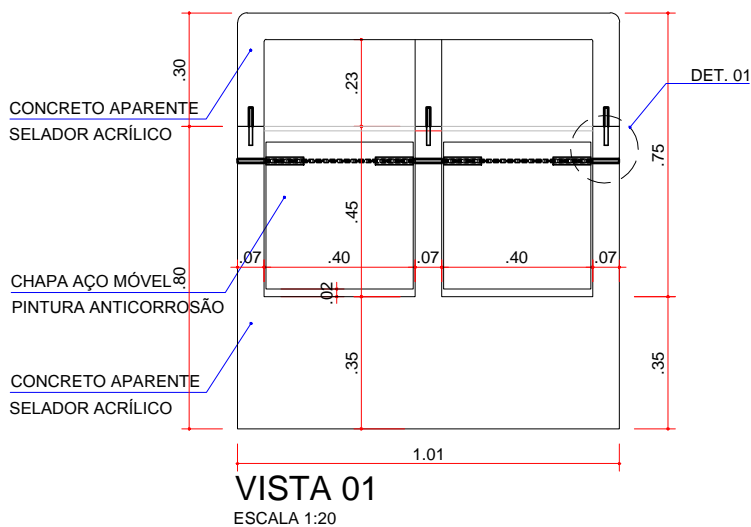
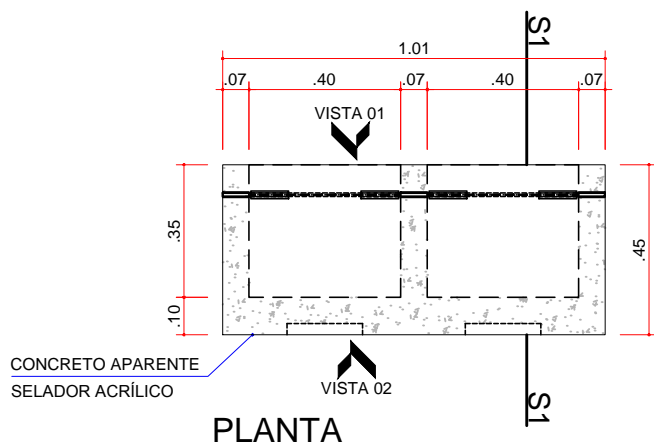

VISTA INTERNA  
SEM ESCALA

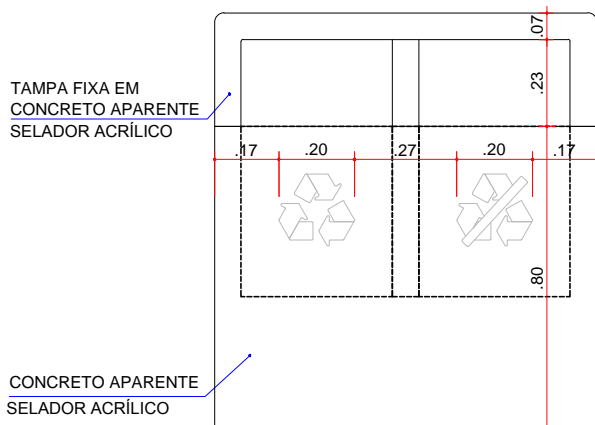

VISTA 02  
ESCALA 1:20

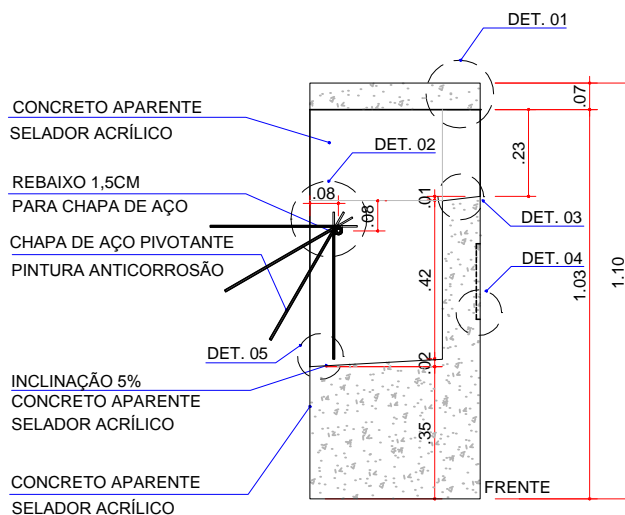

SEÇÃO 01  
ESCALA 1:20

